

SECTION #2

HONEYCOMB SHADES



LEG

20258 NE 15 Ct

Miami FL 33179

TEL: 800/ 446-6867

E-MAIL: sales@legmotorizedsystems.com

Miami FL 33179

FAX: 800/ 446-6442

2-19-10

Motorized Systems

TEL (800 44-MOTOR

RAIL LIFT "CONE SYSTEM"

for

Motorized Soft Shade Duettes

Motor: AM 35 6-28

FT	IN	Dealer
3	36	\$ 312
4	48	\$ 322
5	60	\$ 331
6	72	\$ 340
7	84	\$ 349
8	96	\$ 358
9	108	\$ 367
10	120	\$ 377
11	132	\$ 386
12	144	\$ 395
13	156	\$ 404
14	168	\$ 413
15	180	\$ 423
16	192	\$ 432

**Add A Radio Control
\$75**

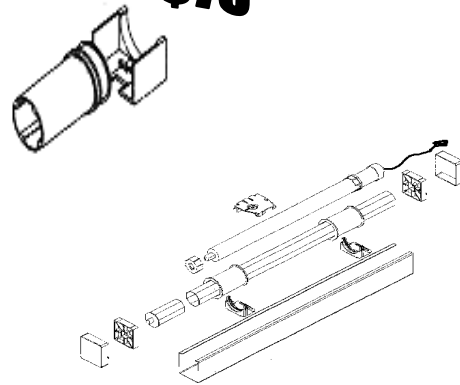



* Max Height Not over 13 ft

Includes switch , plate, motor pigtail
"5" Year Warranty on Motor

20% Add-on for Venetians

**Using our New
& Improved Motors**

Transmitter is Additional

RF 20	Receiver			
				75
AC114-01	transmitter	1- function		24
AC114-02	transmitter	6- function		27
AC114-03	transmitter	16- function		55

LEG Motorized Systems

Motor: AM 35 6-28 E



20258 NE 15 Ct Miami
FL 33179

Ct Miami FL 33179

TEL:305 653-0337

FAX: 305 653-6809

E-MAIL: sales@legmotorizedsystems.com

MOTORIZED SYSTEMS

RAIL LIFT "CONE SYSTEM"

for

Motorized Soft Shade Duettes

Dealer Net

Effective

Feb 17, 2012

FT	IN	Dealer
3	36	\$ 366
4	48	\$ 376
5	60	\$ 385
6	72	\$ 394
7	84	\$ 403
8	96	\$ 412
9	108	\$ 421
10	120	\$ 431
11	132	\$ 440
12	144	\$ 449
13	156	\$ 458
14	168	\$ 467
15	180	\$ 476
16	192	\$ 486

BUILT IN RF

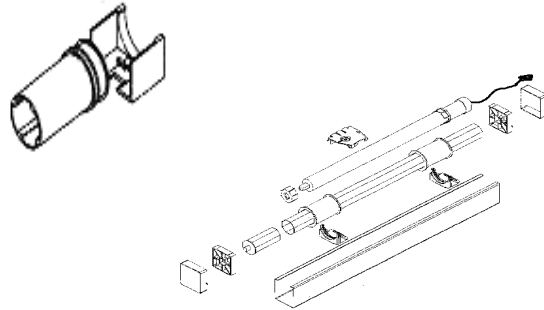



* Max Height Not over 13 ft

"5" Year Warranty on Motor System

Using our New & Improved Motors

Add'l 20% for Venetians

Transmitter is Additional

AC114-01	transmitter	1-function		24
AC114-02	transmitter	6-function		27
AC114-03	transmitter	16-function		55

Coming AM35 E QUIET ELECTRONIC



MOTORIZED SYSTEMS

LEG Motorized Systems

20258 NE 15th Court Miami, FL 33179 USA

TEL: 800 44MOTOR (446-6867)

FAX: 800 446-6442

TEL: 305 653-0337

FAX: 305 653-6809

E-Mail: sales@legmotorizedsystems.com

CONE & CRADLE RAIL LIFT SYSTEM

for

SONESSE 40 QUIET MOTOR RTS

Motorized Soft Shade HONEY COMB & *Venetians

Dealer Net

Effective

3/19/2012

FT	IN	Dealer
3	36	\$ 729
4	48	\$ 739
5	60	\$ 749
6	72	\$ 759
7	84	\$ 770
8	96	\$ 780
9	108	\$ 790
10	120	\$ 800
11	132	\$ 810
12	144	\$ 820
13	156	\$ 830
14	168	\$ 840
15	180	\$ 850
16	192	\$ 860

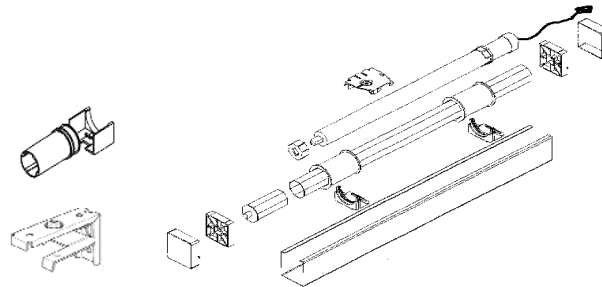

CONTROLS

Telis 1	1810632	54
Telis 4	1810633	69
Telis 16	1811020	225
RS 232 Wireless	1810872	295
Adapter		16

* Max Height Not over 13 ft

"5" Year Warranty on Motor System

VENETIANS Additional 20%



MOTORIZED SYSTEMS

LEG Motorized Systems

20258 NE 15th Court Miami, FL 33179 USA

TEL: 800 44MOTOR (446-6867)

FAX: 800 446-6442

TEL: 305 653-0337

FAX: 305 653-6809

E-Mail: sales@legmotorizedsystems.com



MOTORIZED SYSTEMS

LEG

Motorized Systems

20258 NE 15 Ct Miami FL 33179

TEL 800 44-MOTOR

FAX: 800 446.6442

E-MAIL: sales@legmotorizedsystems.com

REEL LIFT "RAIL SYSTEM"

for AM 35 Motor with "RF"

Motorized Soft Shade & HONEYCOMB

Dealer Net

Effective

3/24/2012

FT	IN	Dealer
3	36	\$ 624
4	48	\$ 646
5	60	\$ 668
6	72	\$ 689
7	84	\$ 711
8	96	\$ 733
9	108	\$ 754
10	120	\$ 776
11	132	\$ 798
12	144	\$ 820
13	156	\$ 841
14	168	\$ 863
15	180	\$ 885
16	192	\$ 907

Min size	25 x 200
Max size	192 x 200 (Gutter Rail)
<i>Max size</i>	216 x 200 COMING

INCLUDES 1- Function RF Transmitter

"5" Year Warranty on Motor System



LEG Motorized Systems

20258 NE 15th Court Miami, FL 33179 USA

TEL: 800 44MOTOR (446-6867)

TEL: 305

FAX: 800 446-6442

FAX: 305

653-6809

LEG RAIL for Motorized: Soft Shade_ Duettes & Venetians

using 2.4" Head Rail with Dbl Shaft AC Motor

USING NEW M850 Motor

			Dealer Net	
FT	IN	Duettes	Venetians	
3	36	478	+ 20%	
4	48	486		
5	60	494		
6	72	503		
7	84	511		
8	96	519		
9	108	527		
10	120	536		
11	132	544		
12	144	552		
13	156	560		
14	168	568		
15	180	577		
16	192	585		

Effective Feb-12

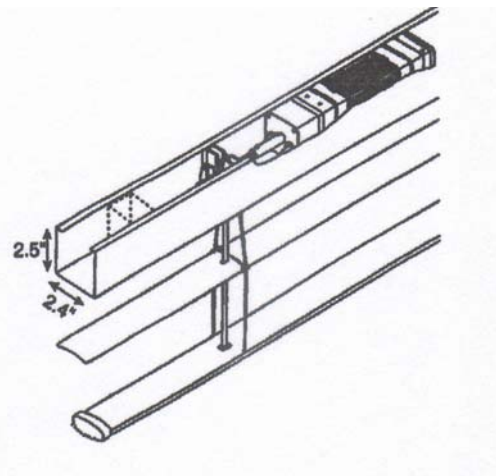

5 Year Warranty on Motor System

ADDITIONAL ITEMS

coupling stri or Universal	20
lift tape 1/4"	0.3
lift tape 1/8"	0.3

Non-Mtr Rail sold with a drive

driving motor rail	10	/ft
mounting shade on Non-Mtr Rail	40	
MIN. Non Motor Rail Charge	40	

1-Motor Does the JOB

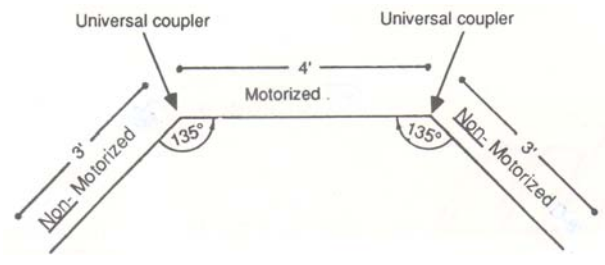

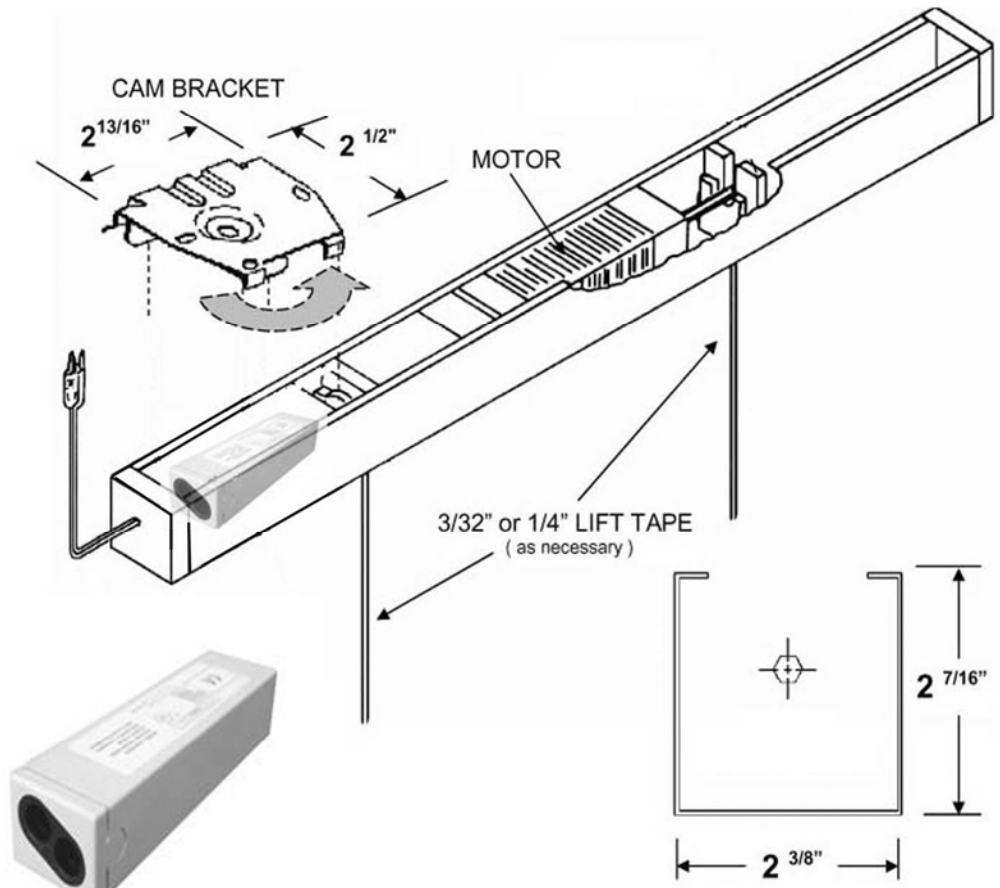

**NOTE: Rail Also fits in 2" Rail
with CONE System**

RF 20 Radio Receiver in Duette Rail		
DATE June-18-08	DRAWN BY Cherin	APPROVED BY
SCALE	REVISED	
LEG Motorized Systems 20258 NE 15th Ct Miami FL 33179 TEL 800 44-MOTOR 305 653-0337 FAX 800 446-6442 305 653-6809 email: sales@legmotorizedsystems.com		DATE APPROVED
		DRAWING NUMBER

FILE: lit/ Duette Order Info

UPDATE: Nov-09

April- 04-2011

HOW TO ORDER DUETTE SHADES or Venetians FOR "MOTORIZATION" OR Any Other Type of SOFT-Shades to be motorized

1 Head Rail & Bottom Rail = Same Size as FABRIC BOTH RAILS SHOULD BE THE SAME TYPE. (NOT "Easy-Rise" type)

2 Fabric to be Punched, Not More than 8".... from ends.

NOTE: Greater is OK

3 Top Insert in Fabric Must Have ¼" "thru Holes"

4 **PUNCH TOP & BOTTOM RAIL TO HAVE "THRU HOLES ON BOTH"**



***If Radio IR or RF Control is in Rail.. Must have at least 8"**

Require at least 24" spacing between holes for motor to fit

NOTE: Only if we are NOT using Cone System

1 Grommets in Head Rail

2 "Easy-Rise" Plugs & Sleeves in **Bottom Rail & HOLES IN TOP RAIL**

3 NO Control Lock

4 NO Cords for Duettes NOTE: for Venetian. Use cords to hold slats

5 Package Brackets with Order *10. ON WOOD BLINDS. "ROUTE HOLES" *required whenever you have ladders.*

Need this for Distribution of weight **NOTE:**
if you order Venetians without Head rails... Order
the LADDERS 15" longer than you're ordering
Height. Called "STACK-PACK"

11. WE SUGGEST SENDING A COPY OF THIS SHEET with ALL orders.

MOTOR SPEC

A. Double Shade Motor Cone & Cradle System **SPECIAL NOTE ON ORDERING WOOD BLINDS *Order as STACK PACK from Vendor. This will give you 15" of Ladder on Top and 15" on bottom **VENDOR will NOT have to give you Headrail. Be sure they do Give you the valance and the Bottom Wood-lugs for the Holes. You do NOT require mounting hardware.

These are the Spec's to Provide when YOU are ordering

A Blind that will be either:

A. Cone System, B. or Conventional Older Style System